



**Building A - Asking Rent: 270-280€/sqm/year + VAT**  
**Car parking n° 130 – Asking Rent: 1.850€/unit + VAT**  
**Moto arking n° 95 – Asking Rent 400€/unit + VAT**

### General Characteristics

- Image and representation
- High Standing Finishings
- Floating floors, suspended ceilings
- Class to be assigned at the end of the restructuring
- International Grade A Building
- LEED Certification

**Availability:** immediate



For further information:

**Andrea Zanierato**  
02 63799 212  
[andrea.zanierato@cushwake.com](mailto:andrea.zanierato@cushwake.com)

Cushman & Wakefield LLP  
Via Turati 16/18  
20121 Milano

FLOOR	AREA	USE	RENTAL FEE
8	1,980smq	office	€280/smq/year
7	1,980smq	office	€270/smq/year
6	1,980smq	office	€270/smq/year
5	1,980smq	office	€270/smq/year
<b>total</b>	<b>7,920smq</b>	office	

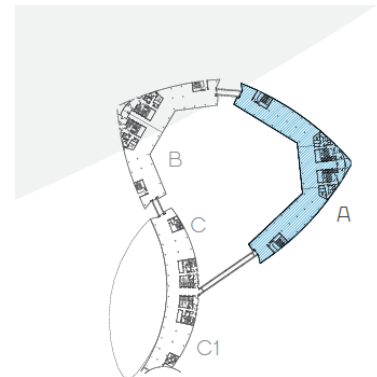
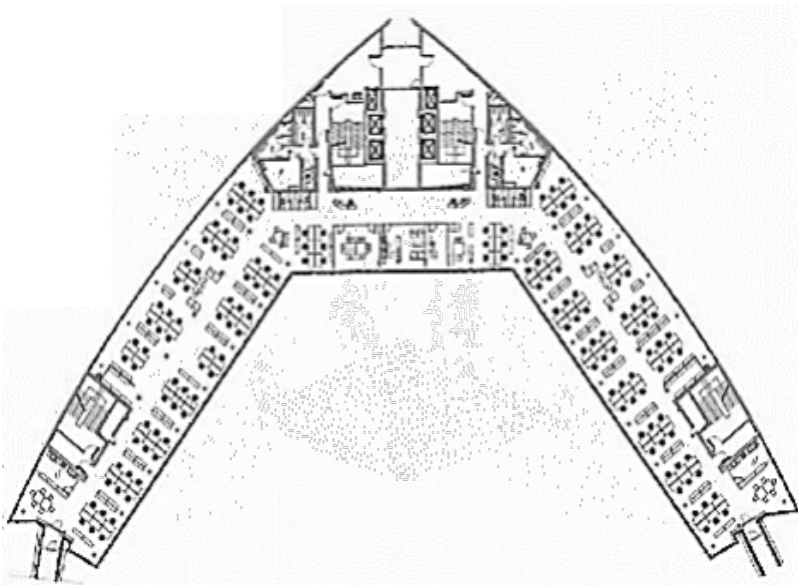
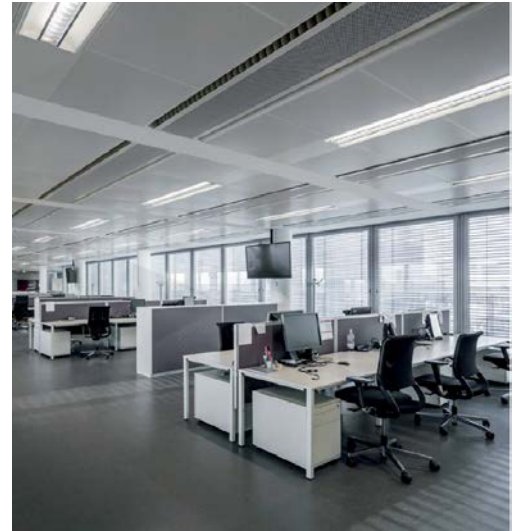

### Location

The property is located in the South West quadrant of the metropolitan area, in the business district of Lorenteggio.

Well connected to the main roads of Milan, the building is served by the M1 and the future M4 under construction.

MM1 Bisceglie (1.km)

MM4 San Cristoforo (2022) (600m)

Stazione San Cristoforo (600m)

Tram & Autobus

14 – 49 - 64

Taxi Services

